



KURIYAMA

AUSTRALIA PTY LTD

The Flexible Rising Main System



THE FLEXIBLE ROFLEX WEL



OROFLEX WELL is an innovative flexible rising main system designed for use in ground water extraction. Developed by a team with over 40 years' experience of producing extruded, circular woven polyurethane hoses. Tens of thousands of wells have been successfully installed worldwide using OROFLEX WELL hoses.

Oroflex Well has quickly gained world-wide acceptance as a reliable high quality product and is approved for the use of drinking water by NSF of America and complies with the British Standard BS 6920:2014.

The AS/NZS 4020 drinking water approval in progress.

The proven design and performance of **Oroflex Well** ensures a trouble free and cost effective well installation for the pump installer.

Client benefits are many, from lower operating and installation costs to zero water contamination.

In addition to these attributes, fast pump servicing (Minimal headroom required) and a total resistance to corrosion, scaling and attacks by microorganisms mean that **Oroflex Well** is the perfect partner for the well installer.

- Dewatering
- Agriculture
- Industry water supply
- Well point
- Appraisal of water wells
- Water monitoring
- Draining
- Mineral extraction
- Desalination plants
- Marine and offshore industry
- Leachate extraction on landfill sites



Premium Quality Flexible Well Riser System



Specially Designed for Ground Water Extraction and Well Monitoring Operations

Fast Installation and Retrieval
Total Corrosion Resistance

Superior Energy-Saving and Cost Effective Solution

Fully approved for potable water - NSF/ANSI/CAN Standard 61 Certified - BS 6920:2014 Compliant

Applications:

Designed and recommended for ground water extraction and well monitoring operations in different industries such as agriculture, water supply, mining and quarry dewatering, marine and offshore industry, and in the geothermal industry. The OROFLEX WELL System offers many performance advantages and major cost savings over conventional steel, PVC, glass fiber and PE pipes, making it the perfect partner for well installers. Ideal for potable and mineral groundwater extraction, offering fast pump service and total corrosion, microbiological and scaling resistance. Proven performance over 40 years in over tens of thousands of installations.

Physical Properties:

Nominal Inner Diameter		Maximum Working Pressure		Burst Pressure		Maximum Depth		Max. Recom. Load *		Max. Recom. Flow	
inch	mm	psi	bar	psi	bar	ft	m	lb	kg	gpm (US)	lpm
1 ¼	32	505	35	1,160	80	990**	300**	2,200	1,000	50	200
1 ½	40	435	30	1,015	70	990**	300**	3,530	1,600	70	270
2	52	375	26	900	62	990**	300**	5,070	2,300	130	500
2 ½	65	375	26	840	58	990**	300**	5,730	2,600	210	800
3	76	375	26	900	62	990**	300**	6,610	3,000	320	1,200
4	102	375	26	900	62	990**	300**	10,140	4,600	530	2,000
5	127	375	26	840	58	850**	260**	13,230	6,000	790	3,000
6	152	375	26	840	58	850**	260**	21,160	9,600	1,190	4,500
8	203	230	16	600	42	500	150	25,570	11,600	2,110	8,000

(*) The maximum recommended load includes hose weight, cable, couplings, other accessories, pressure at the top of the well and water column weight.

(**) Installations above 660ft (200m) should be consulted before installing.

Only products bearing the NSF Mark are Certified.



The Well Hose

Color:

Blue color is the standard. Other colors are available upon request.



Service Temperature Range:

From -58°F (-50°C) to 150°F (65°C), with peaks of up to 175°F (80°C).

Recommended Operating PH Range:

4 to 9 below 86°F (30°C) and 5 to 9 from 86°F to 122°F (from 30°C to 50°C).

Hose Construction:

Made from circularly woven 100% high tenacity synthetic yarn, completely protected and locked-in by a tough, highly resistant thermoplastic polyurethane extruded through the weave, forming a single homogenous construction without the use of glues or adhesives. Its construction does not permit corrosion or scaling, while giving a high resistance against abrasion and cutting. Easy handling, storage & transport, which allows for fast installation and retrieval.

Ozone Resistance:

No visible signs of cracking will appear due to the ozone.
Excellent weather and UV resistance.

Chemical Resistance:

Exposure to seawater and contamination by most chemical substances, hydrocarbons, oils and greases has no effect on the short or long term performance of the hose. A chemical resistance chart is available and we will supply specific chemical resistance data when requested by the purchaser for unique applications. It is strongly recommended to retrieve the hose from the well when chlorinating water.

Maximum Elongation:

2% under operating conditions.

Maximum Diametral Swell:

10-15% under operating conditions.

Lengths:

Lengths available up to 1,640ft (500 m) reels for diameters from 1 ¼" to 4" and up to 980ft (300 m) reels from 5" to 8" diameters. Other lengths may be available upon request.



Hose Part Number	Nominal Inner Diameter		Hose Tensile Strength		Hose Nominal Weight	
	inch	mm	lb	kg	lb/ft	kg/m
F559299A	1 ¼	32	6,600	3,000	0.19	0.29
F558028A	1 ½	40	10,550	4,800	0.24	0.35
F559364A	2	52	15,450	7,000	0.40	0.59
F558030A	2 ½	65	17,650	8,000	0.52	0.78
F558032A	3	76	19,850	9,000	0.68	1.02
F558063A	4	102	30,850	14,000	0.93	1.38
F558070A	5	127	39,700	18,000	1.30	1.94
F558075A	6	152	63,950	29,000	1.77	2.63
F558076A	8	203	77,200	35,000	2.22	3.30

The OROFLEX WELL hose is fully approved for potable water. NSF (National Sanitation Foundation) certifies that the OROFLEX WELL hose conforms to the requirements of NSF/ANSI/CAN Standard 61- Drinking Water System Components- Health Effects.

The OROFLEX WELL hose meets the requirements of the Water Regulations Approval Scheme (WRAS) Tests on Water Quality / BS 6920:2014 / Cold Water Use.

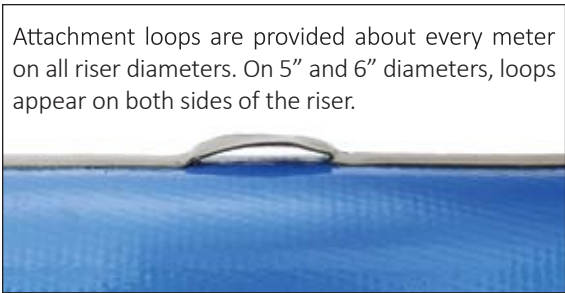

Kuriyama Australia reserves the right to modify any specification without prior notice to meet or exceed changing standards. Customers are advised that special diameters or construction characteristics can be produced upon special request.

The Couplings



A complete range of specially designed high security 316 Stainless Steel couplings is available.



AISI 316 Stainless Steel Expansion Coupling - Small Size							
Coupling Part Number	Thread	Nominal Inner Diameter		Maximum Diameter		Nominal Weight	
		inch	mm	inch	mm	lb	kg
C653058	NPT	1 ¼	32	2.20	56	0.55	0.25
C653200	GAS						



Reusable field-fittable AISI 316 Stainless Steel Conical Couplings								
Coupling Part Number	Emptying Device	Thread	Nominal Inner Diameter		Maximum Diameter		Nominal Weight	
			inch	mm	inch	mm	lb	kg
C655120	-	NPT	1 ¼	32	2.60	66	1.83	0.83
C652995	-	GAS						
C654899	-	NPT	1 ½	40	2.76	70	2.25	1.02
C654898	yes							
C655013	-	GAS						
C655014	yes							
C650089	-	NPT	2	51	3.94	100	5.29	2.40
C655005	yes							
C652990	-	GAS						
C655034	yes							
*	-	NPT	2 ½	65	4.33	110	11.02	5.00
*	yes							
C655200	-	GAS						
C655202	yes							
C650069	-	NPT	3	76	5.12	130	13.67	6.20
C650100	yes							
C652300	-	GAS						
C655011	yes							
C654827	-	NPT	4	102	6.50	165	21.38	9.70
C654826	yes							
C654823	-	GAS						
C654822	yes							
C652341	-	NPT	5	127	7.72	196	29.98	13.60
C652353	yes							
C652355	-	GAS						
C655023	yes							
C652362	-	NPT	6	152	8.94	227	44.31	20.10
C652349	yes							
C652364	-	GAS						
C652363	yes							
C655144	-	NPT	8	203	10.63	270	105.82	48.00
C655143	yes							

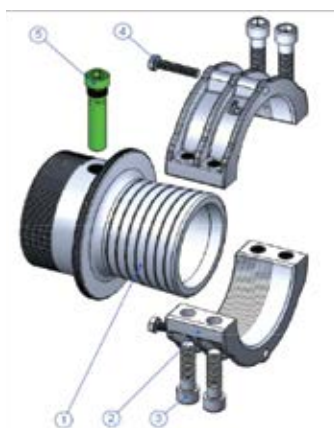

- 1-Coupling shank
- 2-Clamp
- 3-Allen screws (x4)
- 4-Hexagonal jacking screws (x2)
- 5-Draining fuse (x1)

* Please check availability

Other Accessories

Fuse & Plug



Centering Device



Coupling Diameter		AISI 316 Stainless Steel Fuse Part Number	Plug Part Number	Centering Segment Part Number	Type of segment	Segment units
inch	mm					
1 ½	40	C650000	-	-	-	-
2	52	C650002	-	C654202	1 (small bow height)	3
2 ½	65	*	-	C654202	1 (small bow height)	3
3	76	C650003	-	C654202	1 (small bow height)	3
4	102	C651497SS	C651498SS	C654203	2 (medium bow height)	3
5	127	C651507SS	C653051SS	C654203	2 (medium bow height)	4
6	152	C651507SS	C653051SS	C654203 - Option 1	2 (medium bow height)	4
				C654206 - Option 2	3 (large bow height)	3
				C654206	3 (large bow height)	4
8	203	C652325SS				

Fully adjustable centralizers with no pins, bolts, or welding. Easy and rapid on-site assembly with 3 or 4 lightweight segments depending on the hose diameter.

*Check availability

Transparent PU Strap & A316 Stainless Steel Buckle (1)

White PA Protection Saddles & Black Plastic UNE Bracket (2)



Coupling Diameter		Transparent PU Strap Part Number	A316 Stainless Steel Buckle Part Number	White Polyamide Washer Part Number	UNEX Black Flange Part Number
inch	mm				
1 ¼	32	-	-		
1 ½	40	-	-		
2	52	C654743	C654810	C654401	C655096
2 ½	65	C654743			
3	76	C654744			
4	102	C654745		-	-
5	127	C654746		-	-
6	152	C654747		-	-
8	203	C654748		-	-

(1) Ideal for fastening the centering devices and heavy power cables to the well hose. (2) Ideal for fastening power cables typically lighter than 2.70 lb/ft (4kg/m) to the well

Torpedo (Plumb)

Mounting Clamps

Mounting Roller



Coupling Diameter		Torpedo (Plumb) Part Number	Mounting Clamps Set Part Number	Mounting Roller Part Number	Dimensions
inch	mm				
1 ¼	32	C654340	C654310	C654110C	29.5 x 16.5 x 15.7 inch 750 x 420 x 400 mm
1 ½	40				
2	52				
2 ½	65				
3	76	C654360	C654320	C654100C	59 x 33 x 31.5 inch 1500 x 840 x 800 mm
4	102	C654370			
5	127	C654380	C654315		
6	152				
8	203				



KURIYAMA
AUSTRALIA PTY LTD

5 Butterfield Street, Blacktown NSW 2148 Australia

Tel: +61 2 9651 1233

sales@kuriyama.com.au

www.kuriyama.com.au